

MALE END VIEW

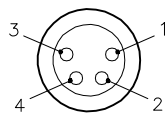

SPECIFICATIONS

CONTACT CARRIER MATERIAL/COLOR	NYLON/BLACK
CONTACT MATERIAL/PLATING	GOLD PLATED BRASS
HOUSING MATERIAL/PLATING/COLOR	NYLON/BLACK
RATED CURRENT [A]	4.0 A
RATED VOLTAGE [V]	36 VDC/ 30 VAC
TEMPERATURE RANGE	-30°C to +80°C (-22°F to +176°F)
MAXIMUM WIRE SIZE	28 AWG

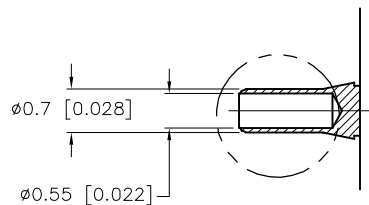
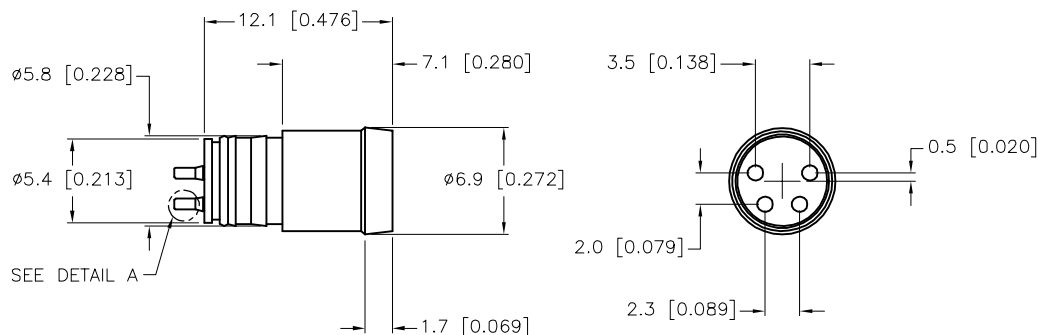

DETAIL A
SCALE 4=1

SOURCE DRAWING - FOR REFERENCE ONLY

RELATED DOCUMENTS 1. 2. 3. 4.	3RD ANGLE PROJECTION	THIS DRAWING IS CONFIDENTIAL AND THE PROPERTY OF TURCK INC. USE OF THIS DOCUMENT WITHOUT WRITTEN PERMISSION IS PROHIBITED.	3000 CAMPUS DRIVE MINNEAPOLIS, MN 55441 1-800-544-7769 (763) 553-7300 (763) 553-0708 fax www.turck.us	
			TURCK	
MATERIAL	DRFT RDS	DATE 07/03/03	DESCRIPTION ESP 4S/S631 (10/BAG)	
FINISH	APVD	SCALE 2=1.0	IDENTIFICATION NO. E3500	
	CONTACT TURCK FOR MORE INFORMATION	UNIT OF MEASUREMENT MILLIMETER [INCH]	REV B	
B ADD 5.8 DIAMETER DIMENSION	RDS	03/07/06	14766	
REV DESCRIPTION	BY	DATE	ECO NO.	
DO NOT SCALE THIS DRAWING			FILE: E3500	SHEET 1 OF 1